



Post Office Lane, Broad Hinton
Guide Price £395,000

*** Desirable Village Location *** A Short Walk To A Local Public House *** 3 BEDROOMS *** Beautifully

*** Official Property Launch Event:
Saturday 20th July 2024. ***

Presented Throughout **** A Homely Feel With Lots Of Charm, Character & Some Period Features On
Show *** Offered 'For Sale' with NO ONWARD CHAIN! *** | Freehold **SOLD STC**

*** Desirable Village Location *** A
Short Walk To A Local Public House &
a highly reputable Italian restaurant ***
Beautifully Presented Throughout *** A
Short Commute To Royal Wootton
Bassett, Wroughton & Marlborough. A
Homely Feel With Lots Of Charm,
Character & Some Period Features On
Show *** Offered 'For Sale' with NO
ONWARD CHAIN! *** 3 BEDROOMS
(Two Doubles & 1 Single). The Ground
Floor Living Accommodation Briefly
Comprises: Living Room,
Kitchen/Dining Room, Inner Hall/Lobby
Area, Bathroom, Separate WC & Utility
Room. Externally There Is A Rear
Garden, Parking Area + An Additional,
Split Garden Area Which In Turn
Provides Potential & Additional
Driveway Parking (Subject To Planning
& Landscaping). Viewing Is Highly
Recommended!

Tenure: Freehold

Parking options: Off Street

Garden details: Private Garden



Whilst every effort is made to ensure the accuracy of these details, it should be noted that the measurements are approximate only. Floorplans are for representation purposes only and prepared according to the RICS Code of Measuring Practice by our floorplan provider. Therefore, the layout of doors, windows and rooms are approximate and should be regarded as such by any prospective purchaser. Any internal photographs are intended as a guide only and it should not be assumed that any of the furniture/fittings are included in any sale. Where shown, details of lease, ground rent and service charge are provided by the vendor and their accuracy cannot be guaranteed, as the information may not have been verified and further checks should be made either through your solicitor/conveyance. Where appliances, including central heating, are mentioned, it cannot be assumed that they are in working order, as they have not been tested. Please also note that wiring, plumbing and drains have not been checked.

Approximate Area = 1164 sq ft / 108.1 sq m
 Limited Use Area(s) = 26 sq ft / 2.4 sq m
 Total = 1190 sq ft / 110.5 sq m
 For identification only - Not to scale

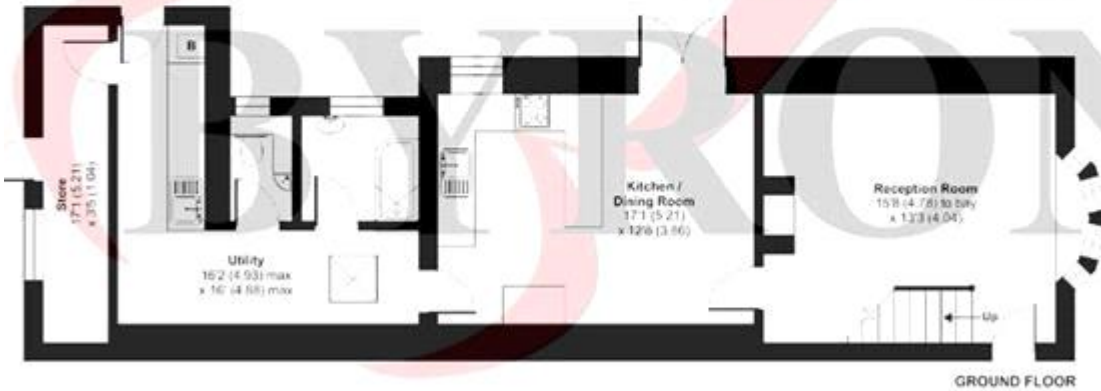

Energy Efficiency Rating		Current	Potential
Very energy efficient - lower running costs			
(92-100) A			
(81-91) B			
(69-80) C			
(55-68) D			
(39-54) E			
(21-38) F			
(1-20) G		17	56
Not energy efficient - higher running costs			
England & Wales		EU Directive 2002/91/EC	

The energy efficiency rating is a measure of the overall efficiency of a home. The higher the rating the more energy efficient the home is and the lower the fuel bills will be.



Viewing by appointment only
 MILES BYRON Real Estate
 MILES BYRON Real Estate, 105 Victoria Road, Old Town, Swindon, Wiltshire. SN1 3BD
 Tel: 01793 200 160 Email: richard@milesbyron.com Website: www.milesbyron.com